

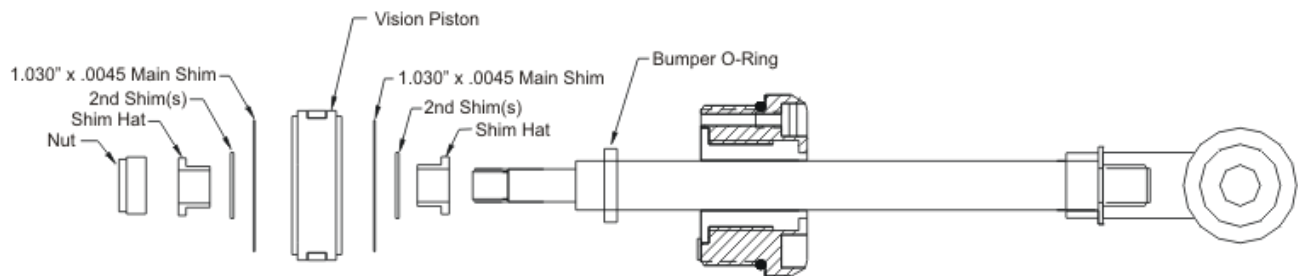

Vision Shock Valving



#3 – Compression - 1.030" x .0045" main shim (qty 1) / .709" x .006" (qty 2)
 Rebound - 1.030" x .0045" main shim (qty 1) / .709" x .006" (qty 2)

#4 - Compression - 1.030" x .0045" main shim (qty 1) / .709" x .008" (qty 1) / .709" x .006" (qty 1)
 Rebound - 1.030" x .0045" main shim (qty 1) / .709" x .008" (qty 1) / .709" x .006" (qty 1)

#5 - Compression - 1.030" x .0045" main shim (qty 1) / .709" x .012" (qty 1) / .709" x .008" (qty 1)
 Rebound - 1.030" x .0045" main shim (qty 1) / .709" x .012" (qty 1) / .709" x .008" (qty 1)

#6 - Compression - 1.030" x .0045" main shim (qty 1) / .709" x .020" (qty 1)
 Rebound - 1.030" x .0045" main shim (qty 1) / .709" x .020" (qty 1)