

Left Lever Assembly
2800-A41-L

| LEFT LEVER ASSEMBLY | | | |
|---------------------|-------------|-----------------------------------|------|
| ITEM NO. | PART NUMBER | DESCRIPTION | QTY. |
| 1 | 2800-A42-L | Upper Cam Lever Assembly - Left | 1 |
| 2 | 2800-A43-L | Cam Ring Threaded Assebmly - Left | 1 |
| 3 | 2800-504 | Grip | 1 |
| 4 | 2800-520 | 3/4-10 Nylon Half Nut | 1 |
| 5 | 3/4" | Narrow Flat Washer | 1 |

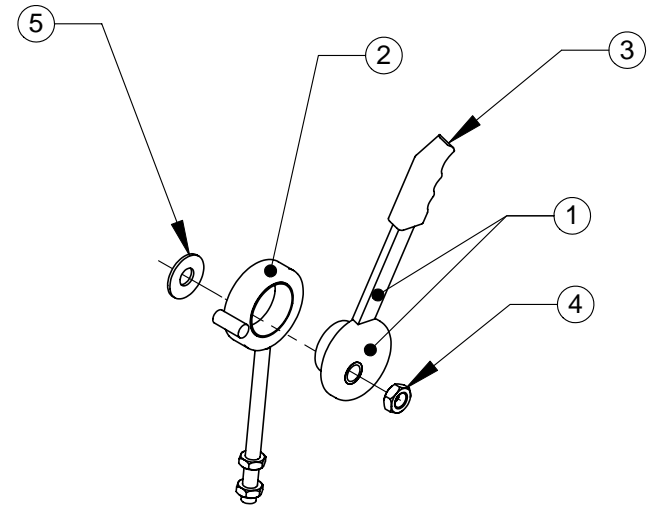

Right Lever Assembly
2800-A41-R

| RIGHT LEVER ASSEMBLY | | | |
|----------------------|-------------|------------------------------------|------|
| ITEM NO. | PART NUMBER | DESCRIPTION | QTY. |
| 1 | 2800-A42-R | Upper Cam Lever Assembly - Right | 1 |
| 2 | 2800-A43-R | Cam Ring Threaded Assebmly - Right | 1 |
| 3 | 2800-504 | Grip | 1 |
| 4 | 2800-520 | 3/4-10 Nylon Half Nut | 1 |
| 5 | 3/4" | Narrow Flat Washer | 1 |

4/1/2010

PROPRIETARY AND CONFIDENTIAL
THE INFORMATION CONTAINED IN THIS
DRAWING IS THE SOLE PROPERTY OF
MITTLER BROS. MACHINE & TOOL. ANY
REPRODUCTION IN PART OR AS A WHOLE
WITHOUT THE WRITTEN PERMISSION OF
MITTLER BROS. MACHINE & TOOL IS
PROHIBITED.

**MB MITTLER BROS.
MACHINE & TOOL**

10 Cooperative Way, Wright City, MO. 63390
(636)745-7757 Fax (636)745-2874

TITLE:
Lever Assemblies

| | | |
|------------------|--------------------------|-----|
| SIZE A | DWG. NO. 2800-A41 E.V | REV |
|------------------|--------------------------|-----|

SCALE: 1:8 | WEIGHT: 472.21\$ | SHEET 1 OF 1